

WISCONSIN MAPPING BULLETIN

Volume 6 No. 1 January 1980

INFORMATION ON CARTOGRAPHIC ACTIVITIES,
MAPPING PROGRAMS, GEODETIC CONTROL
AND AERIAL PHOTOGRAPHIC COVERAGE IN THE
STATE OF WISCONSIN; PUBLISHED QUARTERLY.

Wisconsin State Cartographer's Office

Established 1973

155 Science Hall UW Madison, WI 53706

Art Ziegler
State Cartographer

Christine Reinhard
Editor

CARTOGRAPHIC CATALOGS

County cartographic catalogs are now available for five more counties: FOND DU LAC, TAYLOR, FOREST, PORTAGE, and ADAMS. Automatic distribution of these catalogs is being made to all county offices on our mailing list. Catalogs for EAU CLAIRE, PIERCE, ROCK, and WINNEBAGO Counties have already been distributed. They have been enthusiastically endorsed by all recipients. Admittedly the fact that they are free of charge does enhance their appeal.

The schedule for catalog publication includes those counties indicated on page 1 of volume 5, no. 3 July Bulletin as well as the state's coastal counties. Numerous problems have slowed production but several steps have been taken to increase productivity. Completion of all 72 counties is anticipated within a 2-year period.

PLEASE HELP US

Beginning with this January 1980 Bulletin approximately 1/4 of our readers will receive their copy by first-class mail rather than by bulk mail as it usually is delivered. The purpose of this special mailing is to update and revise our ever-growing mailing list which is approaching 1,200 addresses. Bulk mailing does not allow mail to be forwarded or returned. Therefore a first-class mailing is necessary to trim our long list.

If this copy is the first you've received in a long time, it means we do not have an accurate address for you. Please notify us of your new address or ask us to remove your name from our mailing list. Your prompt cooperation will be very much appreciated, especially by our secretary who has to stuff, seal, and address every envelope.

NEW PUBLICATIONS

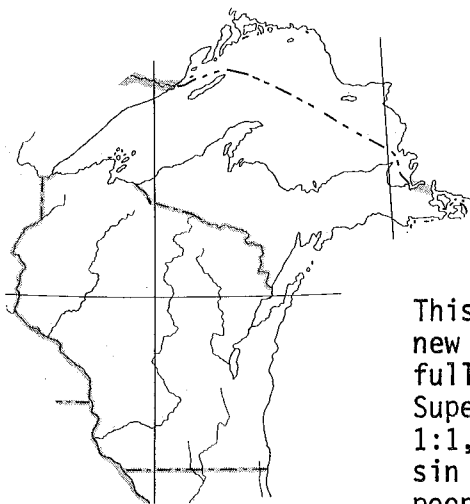

AROUND THE SHORES OF LAKE SUPERIOR: A GUIDE TO HISTORIC SITES by Margaret Beattie Boque and Virginia A. Palmer, 1979, published by the University of Wisconsin Sea Grant College Program and distributed by the University of Wisconsin Press, 114 N. Murray St., Madison, WI 53715 for \$7.95 plus tax (prepaid).

This 179-page book is profusely illustrated with old and new photographs, drawings, and eleven small maps. A large, full-color, folded map showing the historic sites on Lake Superior accompanies the book. This map is at a scale of 1:1,075,000 and was prepared by the University of Wisconsin Cartographic Laboratory. The guide is designed for people touring the Lake Superior shore. It contains information on 113 sites around the lake, beginning at Duluth-Superior and traveling north through Canada, back down through Sault Ste. Marie, and across Michigan and Wisconsin. Numbered entries are keyed to the color map.

AN ANNOTATED BIBLIOGRAPHY OF LAND PLANNING AND LAND INFORMATION SYSTEMS by Bernard J. Niemann, Jr. and David J. Mladenoff. Available from Vance Bibliographies, P.O. Box 229, Monticello, IL 61856. Public Administration Series P 308, \$13.00, 131 pages.

This bibliography contains approximately 300 entries covering all aspects of land planning from inventory and impact and visual assessment to modeling and statistical analysis. Land information system citations include classification systems, remote sensing, cartographic techniques, land records and physical and demographic information systems.

A. C. S. M. STUDENT CHAPTER

Cartography (Geography Dept.) and Surveying (Civil Engineering Dept.) students at the University of Wisconsin-Madison have joined together to form a student chapter of the American Congress on Surveying and Mapping. The objectives of the student chapter are to support the exchange and growth of cartographic and surveying ideas and information; to sponsor speakers and guest lecturers; to coordinate educational field trips; to serve as a channel of communication between faculty and students and to inform the membership of professional and educational opportunities.

Officers are Michael Rynish, Chairperson; Jonathan Doughty, Vice-Chairperson; and Betsy Duckert, Secretary-Treasurer. Joint faculty advisors are Professors Joel Morrison and Phillip Muehrcke of the Geography Department. Christine Reinhard of the State Cartographer's Office is the contact person to A.C.S.M.

NEW MAPS

HUDSON AREA ROAD MAP. 1980 revised edition by the Hudson Area Chamber of Commerce. The 2-color map now includes all of Hudson, St. Joseph and Troy Townships. Several new subdivisions, with their road names, have also been added. Scale is approx. 1 inch = $\frac{1}{2}$ mile. Available free from the Hudson Area Chamber of Commerce, 602 Third Street, Hudson, WI 54016.

COUNTY SCHOOL DISTRICT MAPS have been completed by the Southeastern Wisconsin Regional Planning Commission for the seven counties in their district (WASHINGTON, OZAUKEE, WAUKESHA, MILWAUKEE, WALWORTH, RACINE, KENOSHA). Boundaries of school district areas as of spring 1978 were determined using information obtained from the local Cooperative Educational Service Agency offices or directly from school district offices in the region. These boundaries have been delineated on the SEWRPC's 1" = 4000' scale county base maps. Available from SEWRPC, 916 North East Ave., Waukesha, WI 53186 (494) 547-6721.

LAND USE AND LAND COVER AND ASSOCIATED MAPS FOR ASHLAND WISCONSIN, MICHIGAN, MINNESOTA. This open-file report consists of four maps keyed to the U.S. Geological Survey 1:250,000 Ashland topographic map. These maps are coded for statistical data development. They are 1) land use and land cover, 2) political unit, 3) hydrologic units, 4) census county subdivision. Also included is one positive of the cultural base for Ashland at 1:250,000 (1 inch = about 4 miles). Available from the U.S.G.S. Mid-Continent Mapping Center (NCIC-M), 1400 Independence Road, Rolla, MO 65401.

NEW PRODUCTION FROM U.S. GEOLOGICAL SURVEY

These newly published 7 $\frac{1}{2}$ ' topographic quadrangle maps (1:24,000) are listed by their location on the superseded 15' topographic or planimetric map of the area. They are available from the Wisconsin Geological Survey, 1815 University Ave., Madison, WI 53706 (608) 263-7389. Topographic quadrangles are \$1.50 each.

1 TURTLE LAKE 15' TOPO

NE $\frac{1}{4}$ Alma '78
NW $\frac{1}{4}$ Turtle Lake '78
SW $\frac{1}{4}$ Clayton '78
SE $\frac{1}{4}$ Arland '78

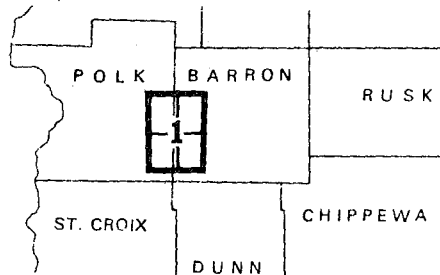

2 OXFORD 15' TOPO

NE $\frac{1}{4}$ None
NW $\frac{1}{4}$ Grand Marsh '79
SW $\frac{1}{4}$ None
SE $\frac{1}{4}$ None

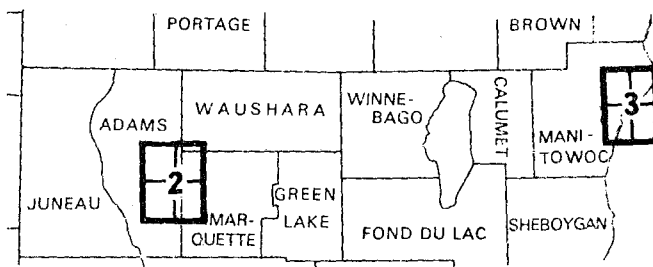

3 MANITOWOC 15' TOPO

NE $\frac{1}{4}$ Two Rivers '78
NW $\frac{1}{4}$ Mischicot '78
SW $\frac{1}{4}$ Manitowoc '73
SE $\frac{1}{4}$ None

NOTE: Order 7 $\frac{1}{2}$ ' quads by name, NOT by the index number used here for location.

* MID - CONTINENT MAPPING CENTER *

The Mid-Continent Mapping Center, U.S. Geological Survey at Rolla, Missouri adopted a new "direct-in dialing" telephone system on December 10, 1979. Listed below are telephone numbers for key personnel:

L. H. Borgerding, Chief Mid-Continent Mapping Center	(314) 341-0880
Walter D. Parkinson, Acting Chief Branch of Cartography	(314) 341-0901
Earl J. Reynolds, Chief Branch of Field Surveys	(314) 341-0887
Howell C. Ogletree, Chief Branch of Photogrammetry	(314) 341-0819
William K. Mengel, Chief Branch of Plans and Production	(314) 341-0861
National Cartographic Information Center (Map information and order)	(314) 341-0851
Geodetic Section (Geodetic control information and orders)	(314) 341-0896

* FEDERAL INTERAGENCY AGREEMENT *

In October 1979 an interagency agreement was signed by the Bureau of Land Management (B.L.M.), Forest Service (F.S.), Fish and Wildlife Service (F.W.S.), Soil Conservation Service (S.C.S.) and the Geological Survey (U.S.G.S.) to achieve the following objectives for the classification and inventory of natural resources:

1. provide guidelines and assure administrative action to minimize duplication and overlapping efforts, and
2. enhance and encourage coordination in overall data collection, data sharing, appraisal efficiency, program compatibility, and to expedite technology transfer.

The proposed schedule for this activity is through June 1981. It involves soils, vegetation, aquatic and landforms categories. The goals are to develop standard classification systems, data element dictionaries, to use compatible inventory techniques, and to develop standards and methods to facilitate data exchange. Soils were selected to be worked on first.

The Council of State Planning Agencies is acting as a liaison between the states and the Interagency group. For additional information or a copy of the agreement, contact Peggy Harwood, Director, CSPA Earth Resources Data Project, 444 North Capitol Street, Washington, D.C. 20001 (202) 624-5386.



CENSUS NEWS

NEW SMSA

On November 14, 1978 a new Standard Metropolitan Statistical Area (SMSA) was designated for Wisconsin. Its title is Janesville-Beloit in ROCK County. The new code number is 3620.

GBF/DIME AND CUE MAPS

Additional 1980 GBF/DIME files have been released by the Bureau of the Census. In Wisconsin three more areas are now available. They are DULUTH-SUPERIOR, MILWAUKEE, and RACINE. Copies of the code-numbered version of the Metropolitan Map Series sheets for these areas are known as CUE maps. They cover the portions of metropolitan areas included in GBF/DIME files. CUE maps are \$2.60 per sheet for a paper copy, \$5.50 per sheet for mylar reproductions, and \$25 per sheet for cronaflex reproductions. Duluth-Superior requires 1 sheet; Milwaukee requires 43 sheets; and Racine requires 48 sheets. Prepaid orders should be sent to Customer Services Branch, Data User Services Division, Bureau of the Census, Washington, D.C. 20233 (301) 763-2400.

COUNTY BUSINESS PATTERNS AND TRANSPORTATION REPORT

The report County Business Patterns, 1977, Wisconsin is now available from the Census Bureau. Order GPO Stock No. 003-024-01712-1 at \$4.75 per copy.

The 1977 Economic Censuses Area Series Report Transportation TC77-T Wisconsin is available for \$2.25 from the Bureau of the Census. Order GPO Stock No. 003-024-01926-4.

Prepaid orders made out to "Commerce-Census" should be sent to Customer Services Branch, Data User Services Division, Bureau of the Census, Washington, D.C. 20233 (301) 763-2400.

★ RESOURCE DATA COLLECTION UPDATE ★ (v. 5, no. 4, p. 2 October Bulletin)

The Department of Administration has started work on the resources data collection plan. Specifically:

1. Working committees have been established to support the Planning Analyst;
2. Study guidelines for resource collection areas are being developed;
3. A revised and reformatted Inventory of Wisconsin Land Resources Data is planned.

D.O.A. is expected to issue investigation and project scope guidelines during the winter months. For further information contact Brenda Hagman, Dept. of Administration, 1 West Wilson Street, Madison, WI 53702 (608) 266-7368.



NEWS FROM S.C.S.

POLK COUNTY

The Soil Survey of Polk County, Wisconsin has been published by the U.S.D.A. Soil Conservation Service in cooperation with the Research Division of the College of Agricultural and Life Sciences of the University of Wisconsin. Major fieldwork for this soil survey was completed in the period 1973-1975. It contains 203 pages of text and tables and 124 soil maps at a scale of 1:15,840. A full color general soil map for the county is also included. Contact the Polk County Soil Conservation Office or the State Soil Conservation Service Office to obtain a copy.

MORE SOIL SURVEYS

Within the next 4 months several more soil surveys will be published. They are: KEWAUNEE, MANITOWOC/CALUMET, DODGE, and SAUK Counties.

IMPORTANT FARMLANDS MAPS

Area Conservationist E.M. Smith of S.C.S.-Eau Claire has provided the following item:

Decisionmakers at all government levels need to know the extent and location of the best farmland to guide future land use decisions and protect the productive capacity of agriculture. The Soil Conservation Service has been given the mandate to make and keep current an inventory of prime, unique, and other significant farmlands of the state. This inventory will be carried out on a countywide basis. Maps are in color and at a scale of 1:100,000. They can be obtained free of charge at the county field offices of the Soil Conservation Service. To date maps are available for ROCK, WASHINGTON, LA CROSSE, and WALWORTH Counties. Brown, Fond du Lac, Kenosha-Racine, Milwaukee-Waukesha, and Ozaukee Counties will be issued in the near future. Eventually all counties with a modern soil survey will also have available an Important Farmlands map.

The Editor welcomes Mr. Smith's contribution and invites others to send in items of cartographic interest.

LAND RECORDS SEMINAR



The Dept. of Landscape Architecture of the Univ. of Wisconsin-Madison School of Natural Resources is offering a seminar on land records issues this spring semester. The seminar will be conducted by Professor Ben Niemann and William Gates. Prof. Niemann was one of the principal investigators in the recent study "Land Records, Cost to the Citizen to Maintain the Present Land Information Base." William Gates has developed a computer-based data system called GRASP (Geographical Resource Analysis Software Package). The seminar will be held every Wednesday morning in 14 Ag Hall on campus. Contact Prof. Niemann at 25 Ag Hall, UW-Madison, (608) 263-7300 for more information and the authorization to attend the seminar.

UPDATE: U.S.D.A. PHOTOGRAPHIC ACQUISITIONS

A.S.C.S. AND S.C.S.





The Agricultural Stabilization and Conservation Service (A.S.C.S.) has acquired photography for 8 more counties since the status report in the October 1979 Bulletin.

Jefferson	1:40,000	Accepted 11/26/79
Kenosha	1:40,000	Accepted 11/26/79
Milwaukee	1:40,000	Accepted 11/26/79
Oneida	1:40,000	Not yet accepted
Racine	1:40,000	Accepted 11/26/79
Vilas	1:40,000	Not yet accepted
Walworth	1:40,000	Accepted 11/26/79
Waukesha	1:40,000	Accepted 11/26/79

The Soil Conservation Service (S.C.S.) acquisition status has not changed.

The graphic shows the combination of both the A.S.C.S. and the S.C.S. aerial photography acquisition programs. See page 6 of the October 1979 Bulletin for an explanation of the duplication in some counties.

 Flown
  Planned by one agency
  Planned by both A.S.C.S./S.C.S.

U.S. FOREST SERVICE

NICOLET NATIONAL FOREST in northeastern Wisconsin was flown by the U.S. Forest Service in May of 1979. (A small part was done in May of 1978.) According to Edwin W. Neumann, Staff Officer in Rhinelander, it is leaf-off, false color, infrared photography at a scale of 1:24,000. The work was flown principally for soil resource inventory. A second set of photos on the ranger districts has proved of great use in forestry and woods road construction. This photography was contracted for the Forest Service by A.S.C.S. in Salt Lake City, Utah which now handles all U.S.D.A. agency photography.

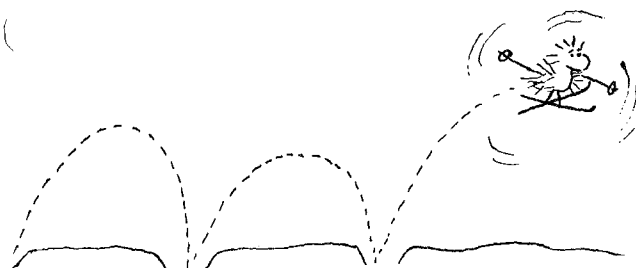
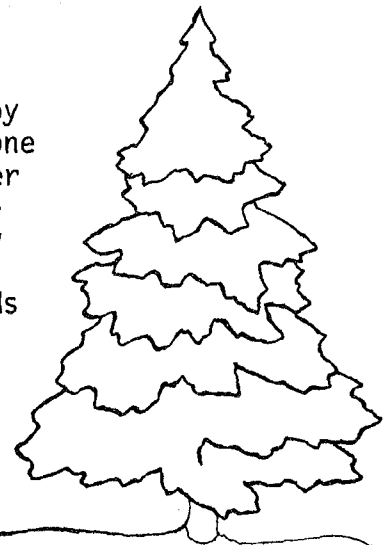

AIR PHOTO ENLARGEMENTS

The completion of the state's unified aerial photography acquisition program (v. 5, no. 4, October) now allows the Special Services Lab of the Department of Transportation to concentrate on processing the 1" = 400' enlargement film positives necessary for making diazo prints. Of the 14,300 enlargements required for monoscopic (non-overlapping) coverage of the state, the Dept. of Transportation in December reported over 63% had been completed (9,000+). The accompanying generalized status map depicts where photo enlargements are available. For specific areas and ordering information contact:

Special Services Section
Dept. of Transportation
P.O. Box 7916
Madison, WI 53707
(608) 266-0309

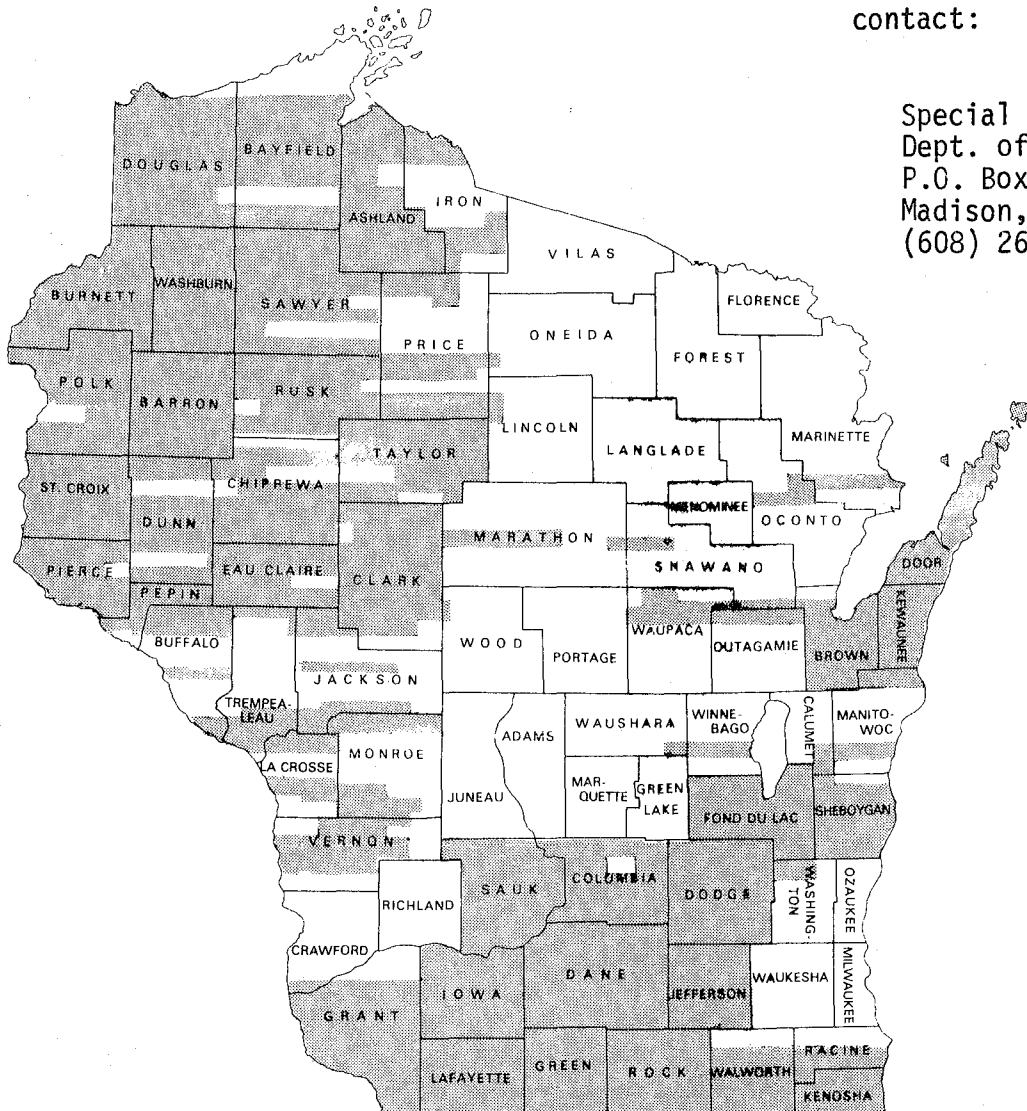

NOTE: All D.O.T. prices for the statewide acquisition photography will change on Feb. 1st. Do not use any prices previously listed in the Bulletin. Before ordering, be sure to call Special Services (608)266-0309.

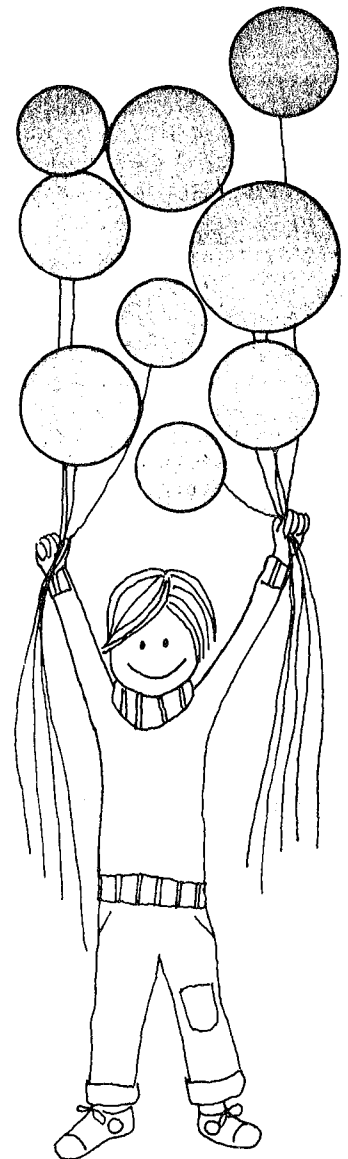

COMING EVENTS



A.C.S.M./A.S.P. NATIONAL CONVENTION

"Progress with a Purpose" is the theme of the 1980 American Congress on Surveying and Mapping/American Society of Photogrammetry convention in St. Louis, Missouri from March 9th through the 14th at the Chase-Park Plaza Hotel. For further information contact: Richard J. Ganahl, Jr., Deputy Director, Registration, 1980 ACSM/ASP Convention, Box 12209 Soulard Station, St. Louis, MO 63157.

WISCONSIN MAP SOCIETY

The fourth annual meeting of the Map Society will be held in Madison on Saturday, June 28. It will include speakers and a tour, to be announced later. Director John Rettig is in charge of arrangements. Any questions regarding the program may be addressed to him in care of the Wisconsin Milestone editor Virginia Schwartz, Milwaukee Public Library, 814 W. Wisconsin Ave., Milwaukee, WI 53233.

COUNCIL OF EDUCATORS IN LANDSCAPE ARCHITECTURE (CELA)

The Council of Educators in Landscape Architecture will hold its annual meeting at the Lakeshore Center on the University of Wisconsin-Madison campus from August 20-23. "Research in Landscape Architecture" will feature an opening session on August 21st at the State Historical Society's auditorium. For more information contact Prof. Darrell Morrison, Dept. of Landscape Architecture, Univ. Wisconsin, Madison, WI 53706 (608-263-7300). *See the call for papers below.*

LANDSCAPE ARCHITECTURE CALL FOR PAPERS

Papers are invited by Prof. Arnold Alanen, Univ. Wis. Dept. of Landscape Architecture, for presentation at the Council of Educators in Landscape Architecture annual meeting in Madison from August 20-23. Papers related to "Research in Landscape Architecture" are requested from persons in a wide variety of disciplines, including educators, graduate students, and practitioners in public and private agencies. Submissions should satisfy at least one of the following themes: 1) establish an intellectual context for a topic, document the research process employed, and present the results obtained; and 2) provide a review and critique of a particular area of research or method. Though not limited to the following, some suggested topic areas are: visual assessment, human behavior and performance, historic preservation, landscape history, design and planning processes, information systems, ecosystem management and restoration, energy conservation in landscape planning, and the teaching of research methods. Interested persons are asked to submit a 400-500 word abstract no later than March 15. Selected papers will be published in a conference proceedings. Send abstracts to: Dr. Arnold R. Alanen, CELA Program, Dept. of Landscape Architecture, Univ. of Wisconsin, Madison, WI 53706 (608-263-7300).

JANUARY 20-26 WAS PROCLAIMED WISCONSIN LAND SURVEYORS WEEK BY GOVERNOR DREYFUS

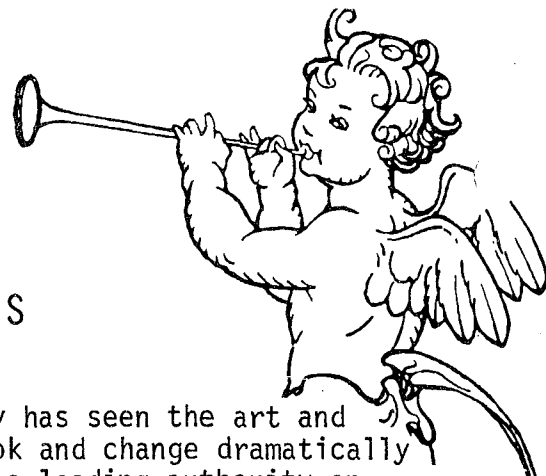

HONORED PROFESSOR RETIRES

A University of Wisconsin-Madison professor of geography has seen the art and science of cartography take on a more philosophic outlook and change dramatically with the impact of computers. A native of Montreal and a leading authority on cartography and geography, Arthur H. Robinson joined the UW-Madison faculty in 1946 and retired on January 1, 1980. He was appointed Lawrence Martin Professor in 1967 and for some years served as director of the University's Cartographic Laboratory and chairman of the geography department. "When I came to the University there was very little cartography," said Prof. Robinson, "and now there is a full-fledged master's program, several staff members and lots of students."

During World War II he was chief of the map division in the Office of Strategic Services (OSS) and was awarded the Army Legion of Merit for his work there. Prof. Robinson contends that cartography started its major growth in the United States after the War and noted the influences of philosophy and technology. "Few people are aware of the perceptual processes by which we are conditioned by maps--how we extract, generalize and organize the information," said Robinson, who compares cartography to linguistics in this respect. "Mapmaking, meanwhile, has been totally changed by the computer and other modern methods," he said. "If we were to take a cartographer out of his laboratory during World War II and put him into a laboratory today he wouldn't know what to do."

Two Simon Guggenheim Memorial Foundation Grants enabled Prof. Robinson to go to Europe in 1964 and 1978 to investigate the history of cartography, particularly the development of thematic mapping. Thematic maps, in contrast with general reference maps, are used to portray specific distributions such as population or climate. "No one ever made these types of maps until the latter part of the 17th century," said Robinson, "and then there was a rapid expansion at the beginning of the 19th century."

He is now conducting a cartographic seminar at the Population Institute of the East-West Center in Honolulu, Hawaii, to help coordinate a working group of Asian cartographers. He will return to his residence in Mt. Horeb at the end of March.

Prof. Robinson is the author of "Elements of Cartography," a standard textbook for cartography classes now in its fourth edition. He also wrote "Look of Maps" published by UW Press and was co-author of the "Nature of Maps" by the University of Chicago Press. He has been president of the Association of American Geographers and the International Cartography Association. Prof. Robinson is one of the few people to be awarded an honorary life membership by the American Congress on Surveying and Mapping. It is said of Arthur Robinson that he is truly a gentleman and a scholar.

A dinner in Professor Robinson's honor is planned for April 11th at the Park Motor Inn, Madison. Full details on the dinner, other planned activities, and reservations can be obtained from the Geography Department Administrative Secretary, Mrs. Shirley Paley, 328 Science Hall, Univ. Wisconsin, Madison, WI 53706 608/262-3129



AIR PHOTO MICROFICHE

A new microfiche reference system is available to users of aerial photography flown over the United States. Called the Aerial Photography micro(graphic)-INDEX, this system references several million frames of both NASA research and USGS mapping photography, maintained at the EROS Data Center.

The micro(graphic)INDEX is keyed to the U.S. Geological Survey's 1:1,000,000 scale map series, consisting of 4°x 6° quadrangles of the contiguous United States. Additional indexing based on photo scale, film type, and date of acquisition is provided. The smallest unit of fiche which can be purchased is that which references one entire 4°x 6° quad. A unit can reference small to large scale photography, and black-and-white, color, or color infrared film. Prices vary based on the amount of aerial coverage associated with a specific quad. They range from \$5 to \$65.

For additional information on this system, or to place orders for microfiche, contact the User Services Section, U.S. Geological Survey, EROS Data Center, Sioux Falls, South Dakota 57198, phone (605) 594-6511.

1979 INDEX

Aerial photography *see also* Statewide acquisition; Orthophotoquads
U.S.D.A., no. 2, p. 3; no. 3, p. 3;
no. 4, p. 6; no. 4, p. 7

Atlases
Upper Great Lakes, no. 2, p. 6
Midwest forest, no. 2, p. 6

Conferences and meetings--no. 1, p. 2;
no. 2, p. 8; no. 3, p. 6; no. 4, p. 9

County cartographic catalogs--no. 3, p. 1;
no. 4, p. 9

Dane County
aerial photography, no. 4, p. 5
glacial geology, no. 3, p. 5
rural landscape, no. 3, p. 5

Door County
road map, no. 3, p. 5
soil survey, no. 4, p. 6

Eau Claire Co. catalog--no. 4, p. 9

Federal mapping funds--no. 1, p. 1

Geodetic information
horizontal control, no. 2, p. 7
redefinition of networks, no. 3,
p. 2

Highway safety map design--no. 2, p. 8

Index 1978--no. 1, p. 6

Jefferson Co. soil survey--no. 4, p. 6

Land records
land information systems, no. 3, p. 2
land records project, no. 2, p. 7
publications, no. 3, p. 8

Maps *see also* Topographic maps
American Geog. Soc., no. 2, p. 2
census, no. 3, p. 8; no. 4, p. 4
congressional districts, no. 4, p. 5
Door Co. road map, no. 3, p. 5
Dept. of Trans., no. 4, p. 5
ecoregions, no. 4, p. 4
glacial geology Dane Co., no. 3, p. 5
historic Wisconsin, no. 3, p. 5
Lake Superior, no. 4, p. 5
Lake Winnebago, no. 3, p. 5
land use, no. 4, p. 4

1979 INDEX, cont.

Maps, *cont.*

- national forests, no. 1, p. 5
- North Central States, no. 2, p. 2
- original vegetation Wis., no. 2, p. 4
- Ozaukee & Washington Co., no. 1, p. 5
- peatlands, no. 3, p. 5
- Public Service Comm., no. 2, p. 4
- recreation in Wis., no. 3, p. 5
- rural landscape Dane Co., no. 3, p. 5
- water resources, no. 3, p. 5
- Wis. land resources analysis, no. 3, p. 4
- U.S.G.S. 1:000,000, no. 2, p. 6, no. 4, p. 8
- Upper Mississippi River, no. 4, p. 4
- zip code boundaries, no. 2, p. 4

Orthophotoquads--no. 1, p. 3; no. 2, p. 7

Ozaukee County--no. 1, p. 5

Pierce Co. catalog--no. 4, p. 9

Portage Co. catalog--no. 4, p. 9

Publications

- cartographic records of 1930's, no. 3 p. 2
- Census Bureau, no. 1, p. 4
- coastal mapping handbook, no. 2, p. 2
- guide to American maps, no. 4, p. 10
- land use planning, no. 3, p. 2
- Landsat user notes, no. 4, p. 10
- map projection handbook, no. 2, p. 2
- map use, no. 1, p. 4
- positions of the stars, no. 2, p. 2
- Wis. Geological Survey biennial report, no. 3, p. 2

Resource data collection--no. 4, p. 2

Rock County catalog--no. 4, p. 9

Soil surveys--no. 1, p. 2; no. 4, p. 6

Statewide aerial photo acquisition--
no. 2, p. 3; no. 3, p. 7;
no. 4, p. 1

Survey courses--no. 1, p. 4

Topographic maps *see also* Orthophotoquads
new production, no. 1, p. 3; no. 2,
p. 5; no. 3, p. 7; no. 4, p. 3
status, no. 2, p. 3
1:250,000 revision, no. 2, p. 7;
no. 4, p. 2

Upper Mississippi River Management
Plan--no. 2, p. 1

Washington County--no. 1, p. 5

Wetlands mapping--no. 2, p. 7

Winnebago Co. catalog--no. 4, p. 9

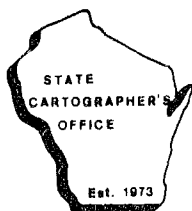
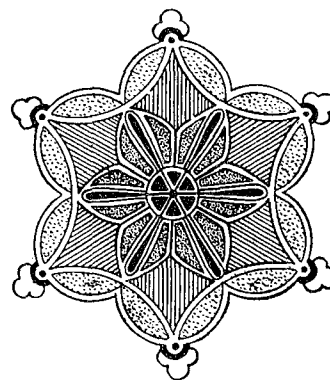

THE WISCONSIN MAPPING BULLETIN IS DISTRIBUTED FREE OF CHARGE ON REQUEST. NEWS ON COMPLETED OR ONGOING PROJECTS, PUBLISHED MAPS OR REPORTS, AND CONFERENCES/WORKSHOPS IS WELCOMED BY THE EDITOR. LOCAL AND REGIONAL INFORMATION IS ESPECIALLY REQUESTED. PLEASE SEND ALL COMMENTS, CORRECTIONS AND NEWS ITEMS TO CHRISTINE REINHARD, STATE CARTOGRAPHER'S OFFICE, 155 SCIENCE HALL, MADISON, WI 53706.