

Agenda

WI Presidents Council

2013 Annual Meeting

Date: Wednesday, October 16th, 2013
Time: 9:00 a.m. to 12:00 noon
Where: Laguna Vista room at the Chula Vista Resort, 2501 River Road, Wisconsin Dells, WI. Conference center is located at the North end of the facility.
Organizer: Jim Lacy, (608) 770-0617, lacy@wisc.edu

Expected Participants: Land Information Officers Network, State Agency GIS Coordination Team, WI County Surveyors Association, WI Geographic Information Coordination Council, Wisconsin GIO, WI Land Information Association, WI Land Title Association, WI Real Property Listers, WI Register of Deeds, WI Society of Land Surveyors, WI State Cartographer's Office.

1. Welcome to Chula Vista - *Rebecca Walters, Chula Vista Resort*
2. Introductions, agenda repair - *Jim Lacy*
3. Follow-up on 2012 meeting - *Jim Lacy*
4. Discussion items
 - a. Act 20 (State Budget Bill) and the initiative to create a statewide parcel map - *Jon Schwichtenberg, WIGICC*
 - b. Draft Department of Revenue Chapter 5 Wisconsin Property Assessment Manual Rewrite - *Michelle Shultz, Real Property Listers*
5. Break
6. Organization updates - *All*
 - a. Each organization has approximately 5-7 minutes to informally report on major issues they expect to address in the next year.
 - b. No PowerPoint please! We will not have a projector available.
 - c. Goal is to promote communication and collaboration between organizations.
 - d. Batting order: SAGIC, WCSA, WSLS, WIGICC, WLIA, LION, WLTA, WRPL, WROD, GIO, SCO
7. Wrap up and closing - *Jim Lacy*
 - a. Review any action items
 - b. 2014 meeting

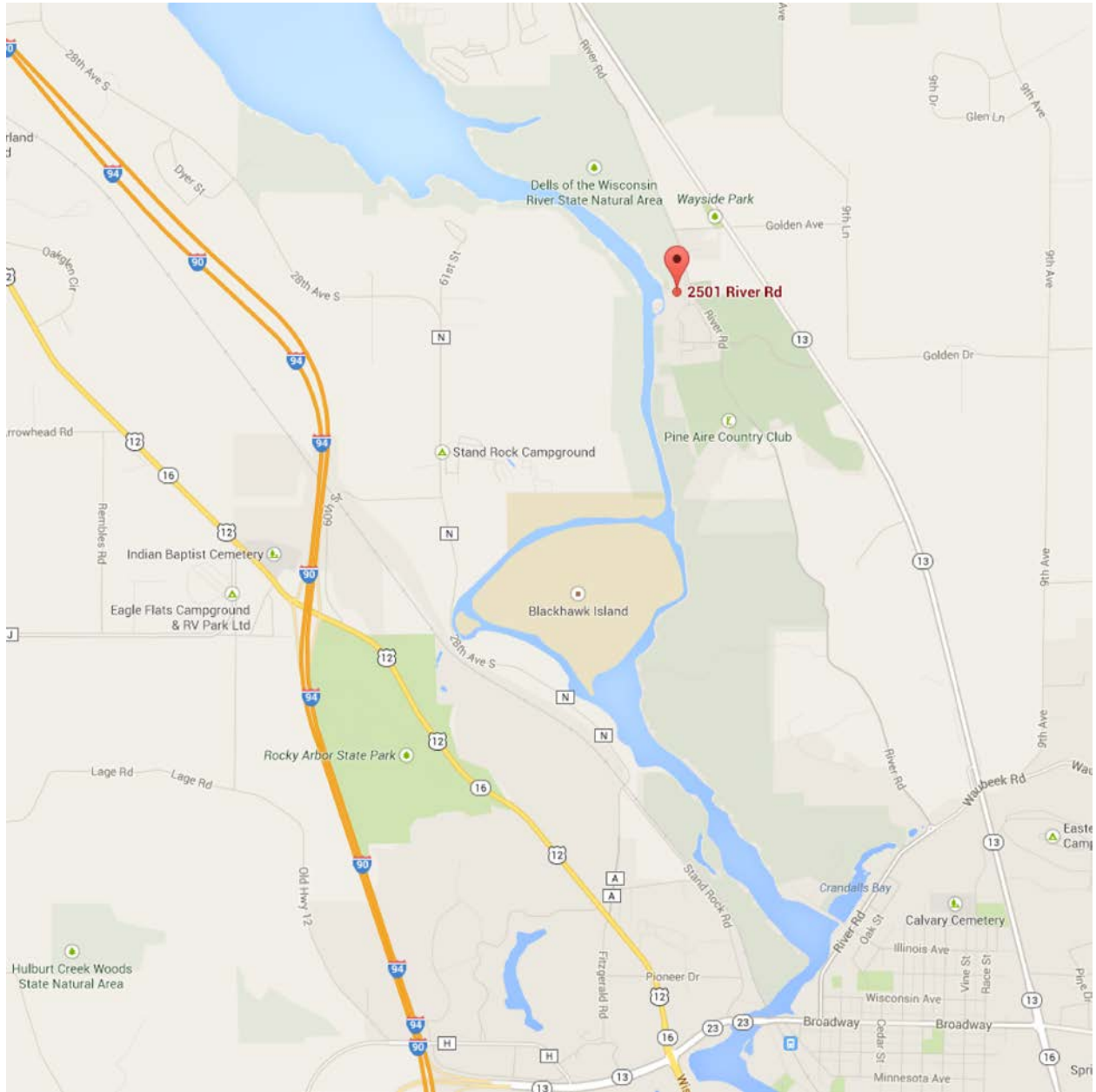

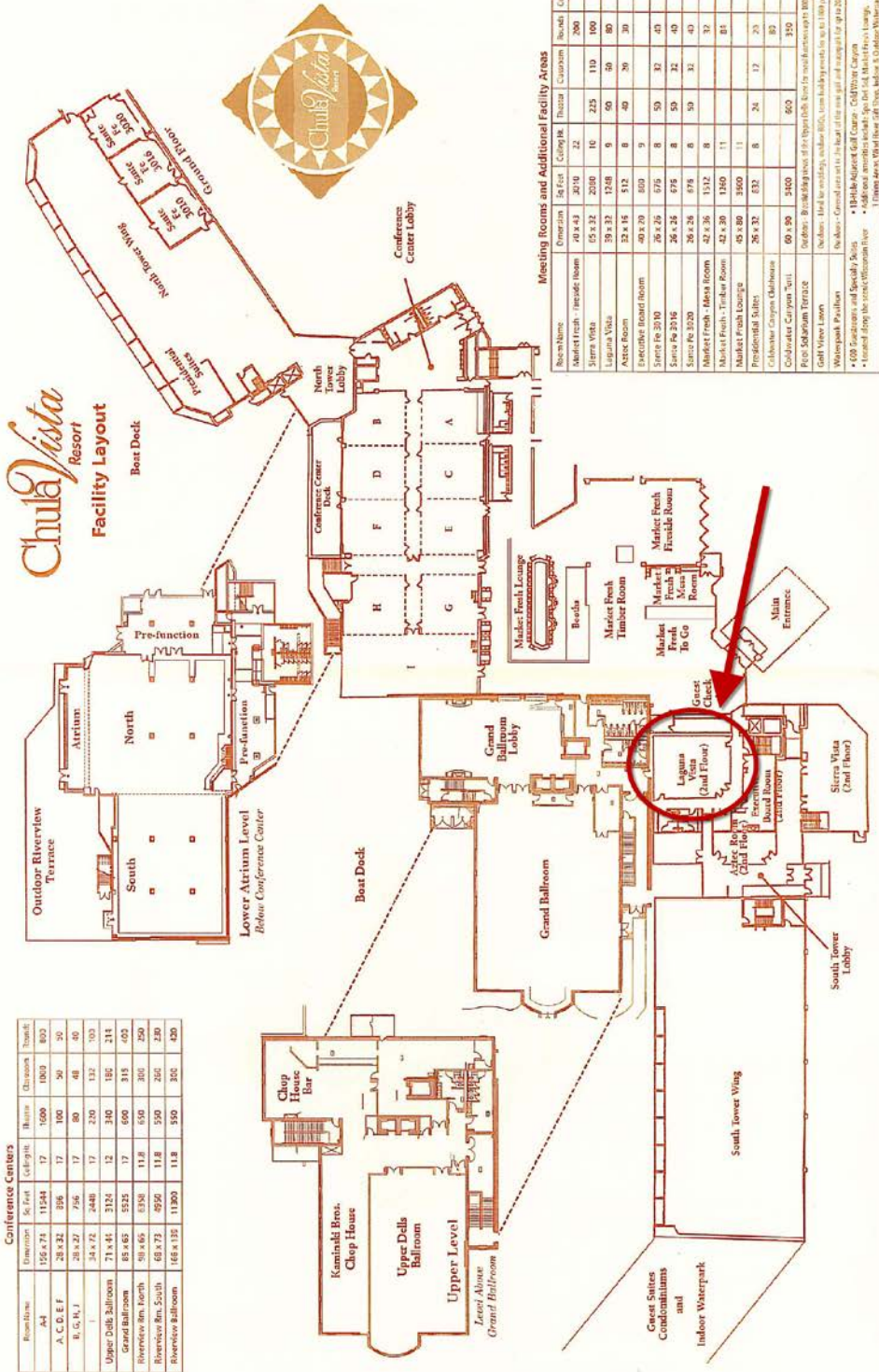

Room/View	Dimensions	Sq. Feet	Capacity	Bar	Classrooms	Theater
A4	126 x 71	11244	17	1000	1000	800
A, C, D, E, F	28 x 21	596	17	100	50	50
B, G, H, J	28 x 27	756	17	80	48	48
Upper Ball Room	71 x 41	2921	12	100	150	214
Grand Ballroom	85 x 65	5525	17	600	315	402
Riverview Rm. North	50 x 45	2250	11.8	500	200	250
Riverview Rm. South	60 x 73	4380	11.8	500	200	230
Riverview Ballroom	168 x 135	11800	11.8	500	300	420

Chula Vista Resort Facility Layout



Room Name	Dimensions	Sq. Feet	Capacity	Theater	Classroom	Booths	Conference
Market Fresh - Inside Room	40 x 43	2010	22	225	110	100	
Market Fresh - Outside Room	55 x 32	2000	16	50	50	80	
Laguna Vista	39 x 32	1268	9	90	38	38	
Active Room	32 x 15	512	8	80	38	38	
Executive Board Room	40 x 20	800	5	50	31	45	
Summit Pk 2010	29 x 25	725	8	50	32	40	
Summit Pk 2016	26 x 24	675	8	50	32	40	
Market Fresh - Meet Room	26 x 28	775	8	50	32	40	
Market Fresh - Trainer Room	42 x 36	1512	8				81
Market Fresh Lounge	45 x 30	1350	11				
Presidential Suites	26 x 32	832	8	24	12	25	12
Clubhouse Canyon Clubhouse	60 x 99	5940	80				159

Meeting Rooms and Additional Facility Areas

Booths: Boarding room, 8 ft. Openable, see in south wing for people
 Booths: Use for meetings, make-up, make-up, make-up, make-up to 100 people
 Booths: General use to be used for the sale of products for up to 200 people
 • 1000 Seating and Specialty Areas
 • 1000 Seating and Specialty Areas
 • 1000 Seating and Specialty Areas
 • 1000 Seating and Specialty Areas
 • 1000 Seating and Specialty Areas